

- ① Installation Pins must be inserted into the Flipper Nut™ at the ends.

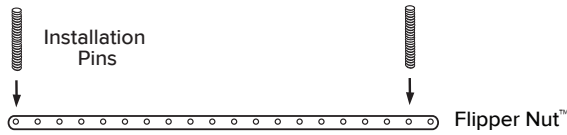

Tools Needed:
• Phillips Screwdriver

- ② **NOTE:** If installing on more than one shelf, start with the bottom-most shelf. Clear product from upper mounting shelf to allow access to holes in shelf.

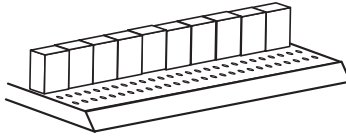

- ③ Allow minimum 1/2" vertical space between product and upper shelf for Invisi-Shield® panel clearance.

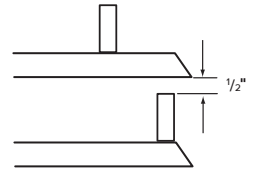

- ④ Slide all Panels into lower track of the Rail.

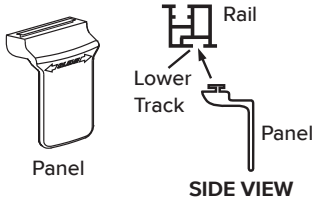

Panel Size	Shelf Length	No. of Panels
3" W	36" L	11
3" W	48" L	15
4" W	36" L	8
4" W	48" L	11

- ⑤ Slide Flipper Nut™ with Installation Pins into top track of the Rail.

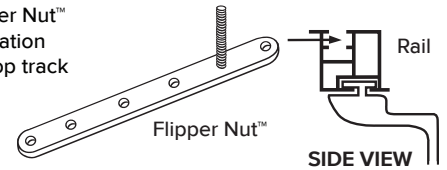

- ⑥ Align Installation Pins in the Flipper Nut™ to the holes in the shelf. **NOTE:** Flipper Nut™ slide easily in the track. Keep Rail level at all times to maintain Flipper Nut™ position.

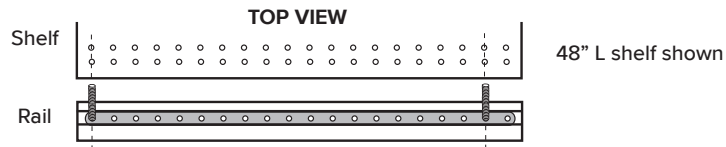

- ⑦ Place Rail under shelf. Align Installation Pins to the rear set of holes at the front of the shelf. **NOTE:** Verify rail is positioned between shelf side supports.

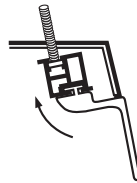

- ⑧ Push Installation Pins through the holes and hold the Rail flush against the bottom of the shelf. **NOTE:** For balance, it is best to hold the rail at the center.

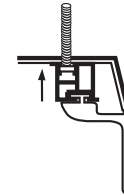

- ⑨ Insert Screw through shelf hole adjacent to Installation Pin and screw into Flipper Nut™. Repeat for remaining screws. After all screws are installed, unscrew Installation Pins. Use (3) screws for 36" L shelf and (4) screws for 48" L shelf.

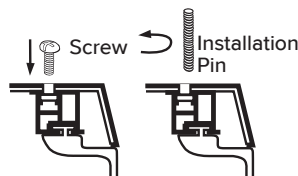

- ⑩ Slide the clear Panels left or right to ensure all products are accessible through the opening. If any of the products are too wide to be removed easily, continue to step 11. If all are accessible, return product on upper shelf. Installation is complete.

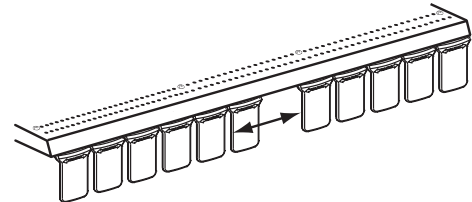
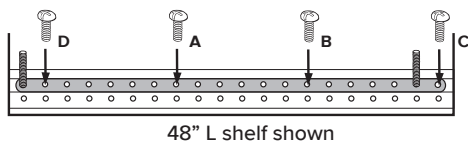

REMOVING PANELS FOR WIDE PRODUCT.

- ⑪ Remove Screw from one end of shelf.

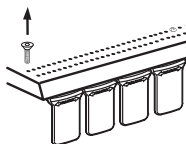

- ⑫ Pull down on the end Panel to bend Rail so that one Panel can be slid out of the Rail.

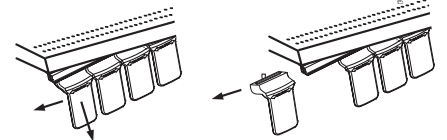

- ⑬ Check fit again by sliding panels left or right to ensure all products are now accessible. If fit is okay, go to step 14. If fit is still too tight, repeat step 12 to remove another Panel.

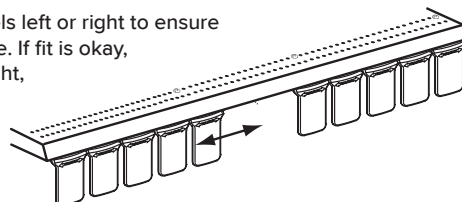

- ⑭ Reinstall the Screw to secure the Rail to the shelf. Return product on upper shelf. Installation is complete.

